

MT. SAN JACINTO COMMUNITY COLLEGE DISTRICT
ADDENDUM NO. 1
BID NO. 2019-015
CONSTRUCTION OF SHADE STRUCTURES AND SITE WORK AT
MENIFEE VALLEY CAMPUS

February 22, 2019

Owner:

Mt. San Jacinto Community College District

1499 N. State Street

San Jacinto, CA 92583

**RECEIPT OF THIS ADDENDUM MUST BE ACKNOWLEDGED ON PROPOSAL WHEN
SUBMITTED**

General

Submittal Due Date – The new proposal submission date is 10:00 a.m. on Thursday, February 28, 2019. Late proposals will not be considered. The District is not responsible for late mail or postal delivery errors. Proposers shall submit one electronic version of the proposal on a flash drive, one (1) printed original proposal including any supporting documentation in a sealed box or package addressed as follows:

Attention: Tammy Cunningham
Mt. San Jacinto Community College District
Purchasing Department
Building 200, Room 223
1499 N. State Street
San Jacinto, CA 92583

Questions

Q1. The existing grades will be lowered approximately 3 feet near the existing retaining wall shown on shade shelter 2 on drawing AS-1.3 detail 8, when the grades are lowered to the new elevations given on the plans, any existing utilities that may be going under the new Hardscape may be exposed because of removing so much dirt, our question is, once we get down the proper elevations, if there are utilities that need to be lowered, please confirm this will be additional work since there is no way to know what may be there, we will per the plans hire an underground utility locator before excavation and drilling the 14 foot footings.

A1. Due to lack of depth information on the as built, any exposed utilities that are too high or too shallow to be protected and maintained in place will have to be re-routed or lowered. This scope will be charged against the allowance or will incur a change order.

However, the drawings address the irrigation per keynote 2.6 on AS-1.3 and this scope should be included in the base bid.

Q2. It was mentioned at the job walk that USA shade will be providing the shade structures and the contractor will be installing them. Do we need to add the shade structure pricing from USA shade as apart of our bid or has the District already purchased them?

A2. It is the Architect's understanding that all shade structures are O.F.O.I. and that they have already been purchasing by the district through USA Shade.

Q3. Please clarify who is installing the shade shelters, my understanding it was owner-supplied contractor installed, I spoke with Michele from the West Coast branch of USA-Shade, and she said that all three shelters were ordered with installation included, please clarify.

Please clarify the rebar size of the vertical reinforcement bars, shown on the footings detail, they call out 26-#4's these normally much larger, this may not matter to us is we are not installing, rebar will be part of the installation of the shelter then.

Do you still want it to be GC's responsibility to use a utility contractor to verify all underground utilities will miss the column layout of the shade structure, or will this now be the responsibility of the school district hired contractor to verify?

A3. Please refer to drawings attached to the addendum.

Q4. Please provide a scope of work to confirm we have not missed something, we see Grass and Irrigation removal and re-working to accommodate new concrete for shelters and we see new concrete area for one hardscape area with no shelter, concrete Benches and hardscape, includes storm drain work, we also see installing 3 district provided shelters in concrete footings.

Will this job be done during the summer when no students are around? Will we need temp fencing around these four areas?

A4. #1 – See addendum for scope. The intent is to start 1 April when the NTP is issued.

Q5. Page 113 of specs under Liability insurance, it states we need not less than 2,000,000 worth of General Liability insurance and this is what we normally provide for MSJCC, but on the bottom of page 113 it talks about an additional 4,000,000 worth of insurance for special hazard insurance, please confirm were not providing the additional 4,000,000 Special Hazards Insurance since were not working around any hazards.

A5. The District is not requesting additional special hazard insurance.

Q6. What is the engineer's estimate for this project?

A6. No cost estimate is available at this time.

Q7. Please provide an idea of what times we may be allowed to perform the following construction task during the normal working hours of 7:00 – 3:30, or any limitations/

1. Demo and removal of dirt and rocks, this will be noisy.
2. Normal construction carpentry, footing work, shade shelter erection.
3. Pouring concrete, may be using a pump, this takes up a lot of room, any limitations on times we can or can't pour concrete?

A7.

1. The 7:00 – 4:00 p.m. work hours will suffice.
2. The 7:00 – 4:00 p.m. work hours will suffice.
3. Standard hours from 7:00 to 4:00 p.m. are ok as long as the entire area of work is protected with surrounding construction fencing (refer to section 01 50 00 and General Conditions. All trucks and pumps shall be within the fenced or barricaded area.

Q8. The footing detail for the 14 foot deep footings for the shade shelter on page 36377-3.2 shows two types of footings, one had to be picked by the District before ordering the shelter, which type will be used for this project? The embedded post or the recessed base plate type, and if the base plate type is used, will the manufacturer be providing the anchor bolts, these are included more than 50% of the time, but not always.

A8. Clarification per attached drawing.

Q9. Please provide a scope of work for the CG for the area around Shade Shelter #3 that sits on the existing concrete that has no new concrete work for us, other than the following items that you may or may not want us to do.

1. Use the utility locator to confirm footing layout will miss all utilities for the 14' deep footings.
2. Provide temp fencing around the work area for Shade Shelter 3.
3. Pour finished concrete on top of the footings after the shelter is completed by districts installer.

- A9. 1. It is the general contractor's responsibility to locate/verify all existing underground utilities and confirm that the shade structure foundations will miss any adjacent existing underground utilities.
2. Contractor will be responsible for protective temporary fencing surrounding the work area.
 3. Contractor is responsible for providing finished concrete.



February 21, 2019

ADDENDUM NO. 1

TO THE CONTRACT DOCUMENTS

FOR

SHADE STRUCTURES AT MT. SAN JACINTO COLLEGE - MENIFEE VALLEY CAMPUS

FOR THE

MT. SAN JACINTO COMMUNITY COLLEGE DISTRICT
1499 North State Street
San Jacinto, CA 92583

DSA No. 04-1176729 File No. 33-C3 RCA Job No. 1-51-07

NOTICE TO BIDDERS

This Addendum forms a part of the Contract and modifies the original documents DSA Approved on November 7, 2018. It is intended that all work affected by the following modifications shall conform with related provisions and general conditions of the contract of the original drawings and specifications. Modify the following items wherever appearing in any drawing or sections of the specifications. Acknowledge receipt of Addendum No. 1 in the space provided on the Bid Form. Failure to do so may subject bidder to disqualification.

GENERAL ITEMS

- Item No. 1.1 General Notes:
- 1.1.1 Shade Structure: The new shades structures, footings, foundation, rebar reinforcement, formwork, excavation, and installation of new shade structure shall be provided by District vendor, USA Shade. Contractor shall identify location of existing underground utilities and/or irrigation to verify necessary clearances for new work, provide grading, removal of spoils and all paving including at shade structure footings. Contractor shall coordinate their scope of work with USA Shade to meet construction and delivery deadlines.

CHANGES TO THE SPECIFICATIONS

- Item No. 1.2 Reference Section 00 01 05 – Project Directory:
- 1.2.1 Revise district contact person to:
Lynn Purper, Interim Dean of Facilities Planning
lpurper@msjc.edu
(951) 487-3396

CHANGES TO THE DRAWINGS

- Item No. 1.3 Reference Sheet T-1 – Title Sheet:
 - 1.3.1 Sheet Index, add new Architectural sheet AS-1.4 – Site Details
- Item No. 1.4 Reference Sheet AS-1.3 – Site Plan Enlarged:
 - 1.4.1 Revise per clouded areas of attached revised Sheet AS-1.3.
- Item No. 1.5 Reference New Sheet AS-1.4 – Site Details:
 - 1.5.1 Add attached new detail Sheet AS-1.4 in its entirety.

ATTACHMENTS

Sheets AS-1.3, AS-1.4

Roger Clarke, Principal
#C-21340

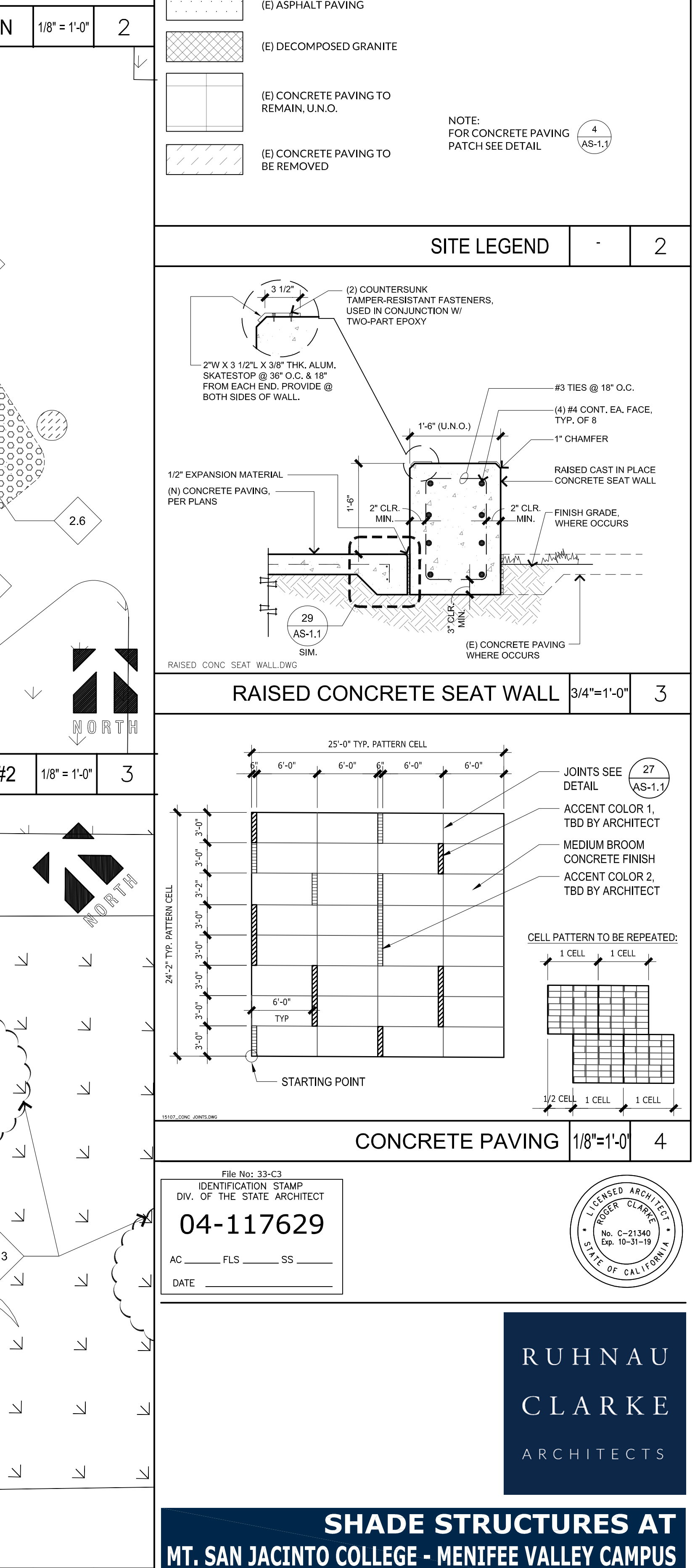
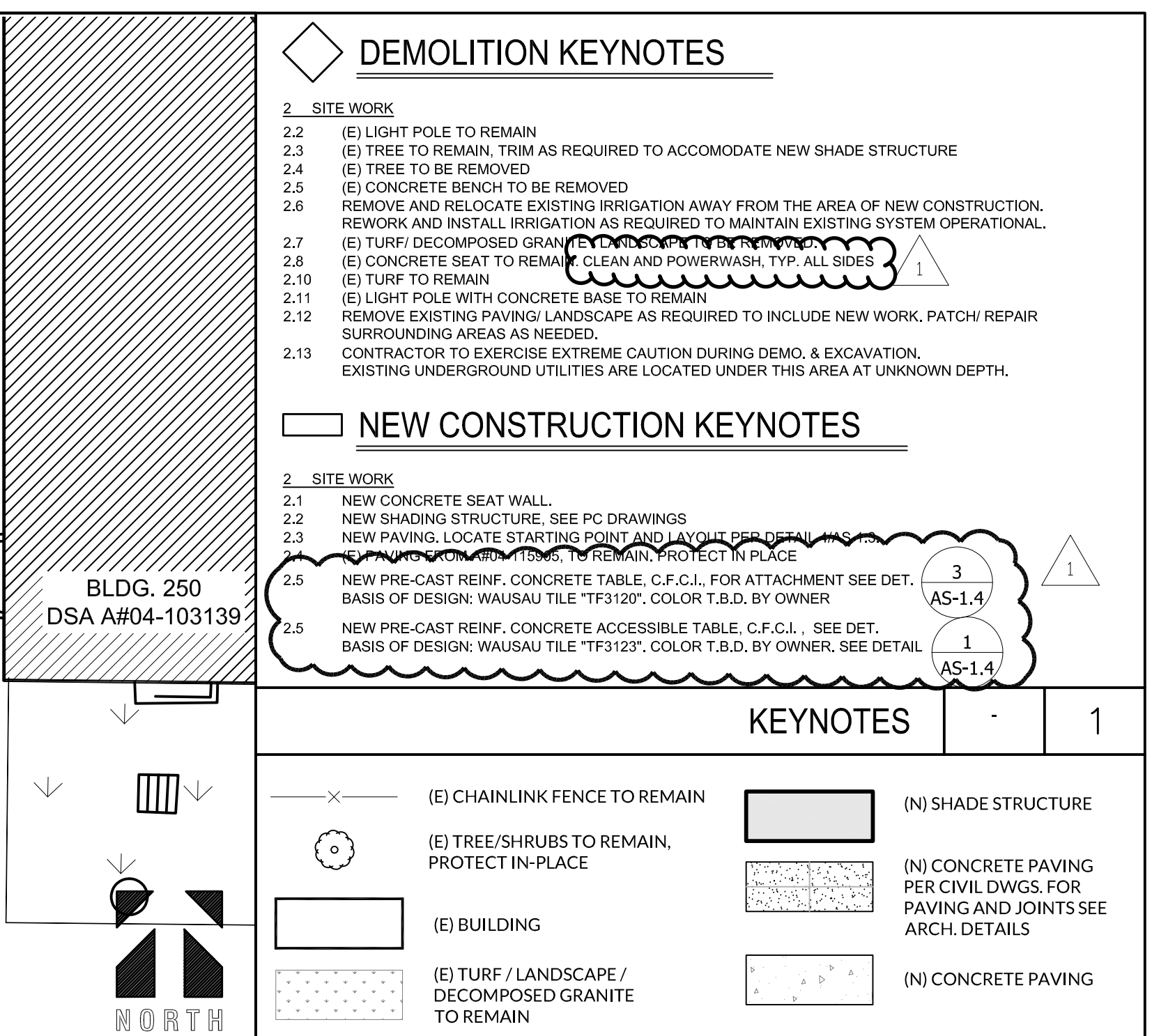

NOT USED

NOT USED

NOT USED

NOT USED

21

16

11

NOT USED

NOT USED

NOT USED

NOT USED

27

22

17

12

NOT USED

NOT USED

NOT USED

NOT USED

28

23

18

13

8

NOT USED

NOT USED

NOT USED

NOT USED

NOT USED

29

24

19

14

9

4

NOT USED

NOT USED

NOT USED

NOT USED

NOT USED

30

25

20

15

10

63 1/16"

VIEW 2

62 1/2"

48"x30"

1

TOP VIEW

Scale: 1/16" = 1"

30 3/4"

TABLE ANCHOR PER DETAIL

3

AS-1.4

VIEW 3

49"

28 1/2"

TABLE ANCHOR PER DETAIL

3

AS-1.4

NOTE:

BASIS OF DESIGN

ACCESSIBLE UNIT: WAUSAU TF3123

STANDARD UNIT: WAUSAU TF3120

FINISH/COLOR T.B.D. BY OWNER

1

2

3

ACCESSIBLE PRE-CAST CONCRETE TABLE

3/4" = 1'-0"

1

PRE-CAST REINFORCED CONCRETE TABLE

PRE-FIN. 3 X 3 X 3 X 3/16" THICK ANGLE, COLOR TO MATCH TABLE (MIN ONE ANGLE PER TABLE LEG)

3/8-16 S.S. INSERT FOR ANCHORING (PROVIDED BY MANU.)

3/8" DIA. HILTI S.S. KB-T2 W/ 2-5/16" MIN. EMBED, PER ICC ESR-1917

PRE-CAST CONC. TABLE BASE ANCHOR

3" = 1'-0"

3

File No: 33-C3

IDENTIFICATION STAMP

DIV. OF THE STATE ARCHITECT

04-117629

AC _____ FLS _____ SS _____

DATE _____

RUHNAU CLARKE ARCHITECTS

SHADE STRUCTURES AT MT. SAN JACINTO COLLEGE - MENIFEE VALLEY CAMPUS

28237 LA PIEDRA ROAD, MENIFEE, CA 92584

MT. SAN JACINTO COMMUNITY COLLEGE DISTRICT

1-51-07

2/19/2019 1:29 PM

J:\MSanJacintoCCD_5115107_SanJacinto&MenifeeCampuses_ShadeStructures\DESIGN\15107MV_AS-1.4_Details.dwg

DRAWN BY:

CHECKED BY:

ISSUE NO. DATE DESCRIPTION

REVISION NO. DATE DESCRIPTION

APPENDIX 01

RUHNAUCLARKE.COM

3775 TENTH STREET, RIVERSIDE CALIFORNIA 92501 (951) 684-6664 / 5751 PALMER WAY, SUITE C, CARLSBAD CALIFORNIA 92008 (760) 438-5899

SITE DETAILS

AS-1.4

1-51-07